

IN ACCORDANCE WITH ANSI/APSP/ICC-5 2011, THE INSTALLER IS RESPONSIBLE FOR PLACING ONE SKIMMER FOR EVERY 800 SQUARE FEET OF SURFACE AREA AND ONE RETURN FOR EVERY 300 SQUARE FEET OF SURFACE AREA.

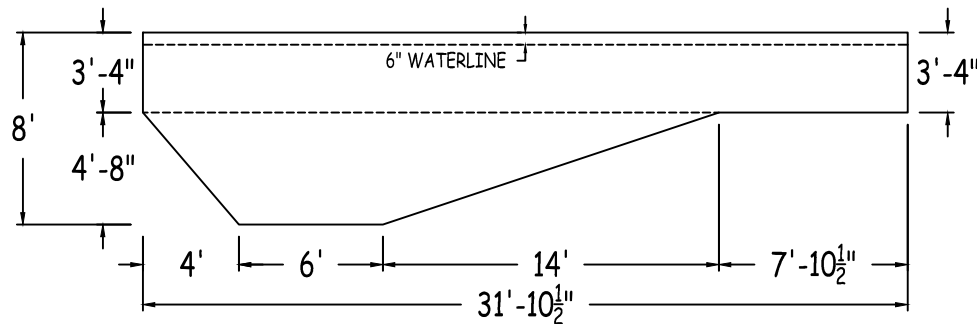
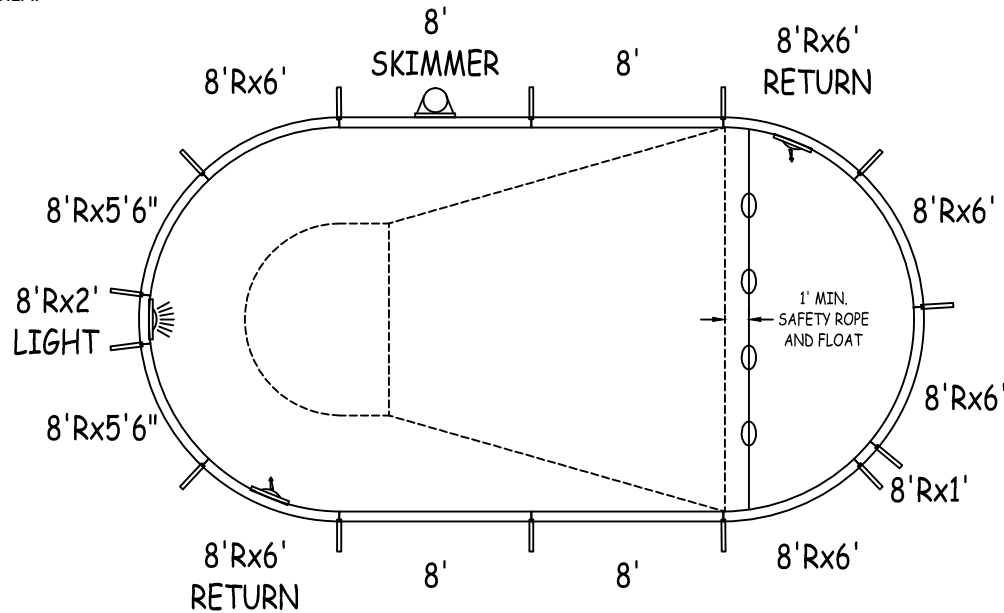
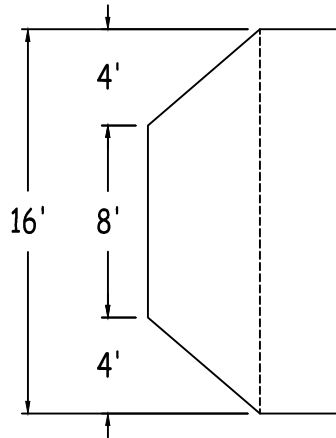

CERT# ESR-2782

UNIVERSAL STEEL

OVAL 16-0 X 31-11

42" STEEL PANELS	PERIMETER:	82'0"	VOLUME (US Gal):	14900
DWG#:	SURFACE (ft²):	455	VOLUME (Liters):	56400
USOV00S1632-13L	LINER (ft²):	510	DATE:	1/1/2013
KIT#:	COVER (ft²):	610	DSR:	76
OV00S1632	SCALE:	1/8" = 1'-0"		



DIVING/SLIDING EQUIPMENT SHALL BE DESIGNED FOR SWIMMING POOLS AND SHALL BE INSTALLED IN ACCORDANCE WITH THE DIVING/SLIDING EQUIPMENT MANUFACTURER'S SPECIFICATIONS. PLEASE CONTACT THE DIVING/SLIDING EQUIPMENT MANUFACTURER FOR THEIR SPECIFICATIONS.

MEETS DEPTH AND SHAPE MINIMUM
STANDARD ANSI/APSP/ICC-5 2011

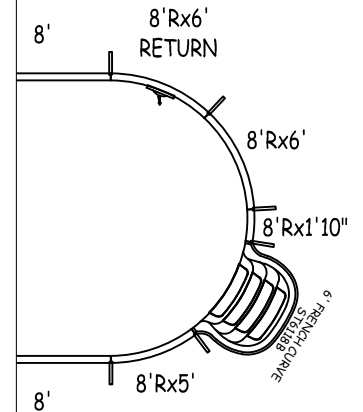

Step Option 1

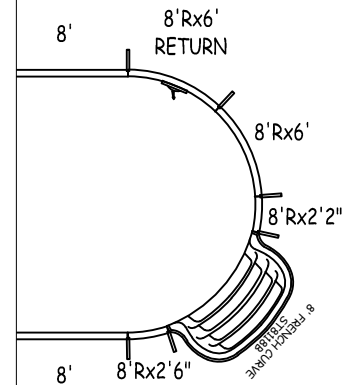

Step Option 2

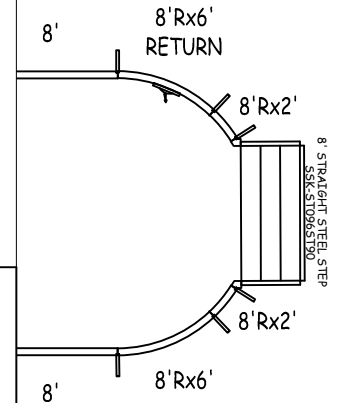

Step Option 3



Center To Center	
1 To 2	15'-10 1/2"
Diagonals	
3 To 4	16'0"
3 To 5	22'-7 1/2"
3 To 6	16'0"
4 To 5	16'0"
4 To 6	22'-7 1/2"
5 To 6	16'0"

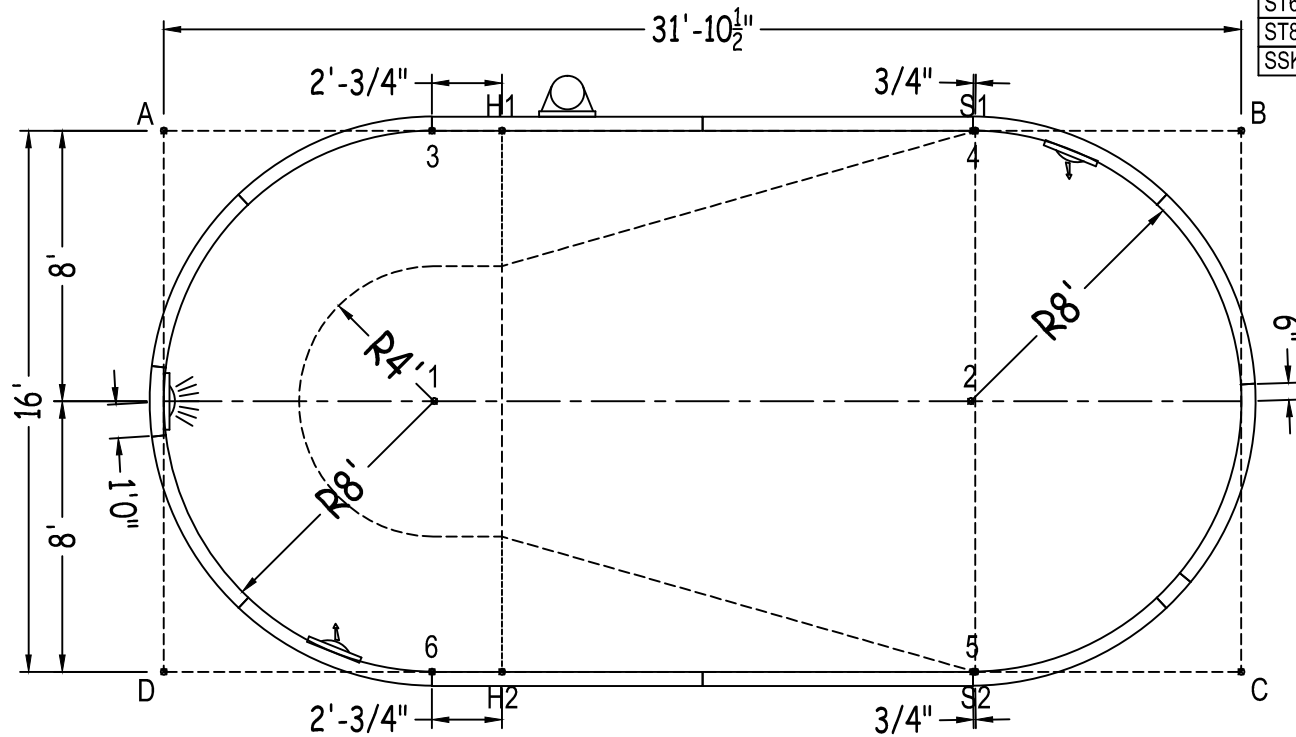

		Base	Option 1	Option 2	Option 3
Part number	Description	QTY	QTY	QTY	QTY
ST0960002X	8'	3	3	3	3
ST0960002*	8' SKIMMER	1	1	1	1
RA0720961X	8'Rx6'	4	2	2	2
RA0720961*	8'Rx6' RETURN	2	2	2	2
RA0660961X	8'Rx5'6"	2	2	2	2
RA0600961X	8'Rx5'	-	1	-	-
RA0300960X	8'Rx2'6"	-	-	1	-
RA0260960X	8'Rx2'2"	-	-	1	-
RA0240960*	8'Rx2' LIGHT	1	1	1	1
RA0240960X	8'Rx2'	-	-	-	2
RA0220960X	8'Rx1'10"	-	1	-	-
RA0120960X	8'Rx1'	1	-	-	-
SSC-TR096S096R	8' STEP IN 8' RAD	-	-	-	2
Brace**	Brace	14	14	14	14
IPC-STKPK25	REBAR STAKE 18" 25PC	2	2	2	2
IPC-HDWSTRT150	BOLT STR 3/8-16X1" C/W NUT 150PC	2	2	2	2
ST6118B	THKSHT STEP FRENCH CURVE 6'	-	1	-	-
ST8118B	THKSHT STEP FRENCH CURVE 8'	-	-	1	-
SSK-ST096ST90	STEEL STEP STR-90D 3 TRD 8'	-	-	-	1

** RECOMMENDED BRACE: IPC-FAF4PC-42

	A	B	C	D
1	11'-3 3/4"	25'-2"	25'-2"	11'-3 3/4"
2	25'-2"	11'-3 3/4"	11'-3 3/4"	25'-2"
3	7'-11 1/4"	23'-11 1/4"	28'-9 1/2"	17'-10 1/4"
4	23'-11 1/4"	7'-11 1/4"	17'-10 1/4"	28'-9 1/2"
5	28'-9 1/2"	17'-10 1/4"	7'-11 1/4"	23'-11 1/4"
6	17'-10 1/4"	28'-9 1/2"	23'-11 1/4"	7'-11 1/4"
S2	28'-10"	17'-10"	7'-10 1/2"	24'0"
S1	24'0"	7'-10 1/2"	17'-10"	28'-10"
H2	18'-10 1/2"	27'-1 1/4"	21'-10 1/2"	10'0"
H1	10'0"	21'-10 1/2"	27'-1 1/4"	18'-10 1/2"
A	-	31'-10 1/2"	35'-8"	16'0"

OVAl 16-0 X 31-11

DWG #: USOV00S1632-13L

DATE: 1/1/2013

SHEET: 2 OF 3

QTY	PART #	DESCRIPTION
4	ST096000-1	8'-0" STRAIGHT
6	RA096096-1	8'-0" X 8'-0" RADIUS
2	RA048096-1	1'-0" X 8'-0" RADIUS [4' TRIMMED]
16	CLIP-1	COPING CLIP
1	COP-TSPK100	SCREW, TEK (100/BAG)
NOTE: SOME COPING PIECES MAY NEED TO BE TRIMMED TO LENGTH AS INDICATED		

